

*Nurture
your
living*

UTTRAKHAND

RERA REGISTRATION NO. :

UKREP09170000023



GREEN VIEW
Blossom
Nurture your living

1/2/3 BHK LUXURY APARTMENT IN DEHRADUN





ABOUT THE PROMOTERS

Realty is what runs in our veins. Having established in 1998, the company within a short span of time has carved a niche for itself and has emerged as a name to reckon with in the field of real estate. Its footprints can be seen as residential complexes in Delhi NCR's (Vaishali & Kaushambi) & group housing in Dehradun's posh localities such as "Silver Rock Apartments" at Curzon road, "Green View Apartments" & "Green View Residency" at Sahastradhara road amongst others and **Green View Height** Raj Nagar Extension, Ghaziabad, (U.P.)

Apart from residential complexes, **GAV Group** has also been the name behind "Hotel Silver Rock" in Mussoorie. Being a growing real estate enterprise, **GAV Group** is ever vigilant to explore new opportunities. Having its forte in affordable luxury segment it seized upon the opportunity that Raj Nagar Ext. (GZB) offered and has come up with 200 apartments complex by the name of "Green View Heights" along with this company going to launch "Affordable Housing And Senior Citizen Homes" with all modern facilities very soon at Haridwar.

What has led the company to the forefront is its commitment towards quality and timely delivery. Adding to its success is the goodwill **GAV Group** has generated from its customers, whose word of mouth publicity have gone a long way in establishing the reputation of the company. Undoubtedly **GAV Group** stand for "Commitment to Customers". The company is sure to scale new heights of success and come up with one more super-hit project "Green View Blossom".

DELIVERED PROJECTS



Green View Heights
Raj Nagar Extension



Silver Rock Apartments
Curzon Road - Dehradun



Hotel Silver Rock
Mussoorie



Green View Apartments
Sahastradhara Road - Dehradun



Green View Residency
Sahastradhara Road - Dehradun

UPCOMING PROJECTS



Possession Offered

Senior citizen homes
with all ultra
modern facilities
at Haridwar

Affordable
Housing In
Dehradun



ABOUT THE PROJECT

Designed at par with international standards, constructed using latest technologies and embellished with utmost care, at **Green View Blossom** you discover pure unadulterated joy. Today, tomorrow and forever. Situated at one of the most stunning locations of Dehradun it makes for an ideal pick both for living as well as investment.

It's an abode of tranquility. Green View Blossom not just offers a luxurious abode but will also fill your life with serenity and uninterrupted joy. The interiors are beautifully decked and features modern and stylish fixtures and plumbing. The sheer grandeur of it will fill you with awe while at the same time offering a cosy home made just for you and your family.

The facilities and amenities are in a class of their own. Truly upscale life at Green View Blossom is akin to 5 Star living that also combines the best of resort like lifestyle. So you not only have a panoramic vista to while away your time but with amenities such as splash pool, gym, clubhouse and sporting facilities assures you of a life that is filled with happiness.

Homes that will take your breath away. Literally. Epitomising fine living, Green View Blossom is a sprawling complex designed aesthetically. Surrounded by beautifully landscaped surroundings it carries the theme of nature even inside the house and in the process giving you a home that is open, permits the flow of natural breeze and has ample natural light.

Low population density area	Approx 70% Open Area
Wide road with green planted roadways	24x7 power back-up for essential service
Manned entry and exits	2 High Speed Lifts for each blocks
Unmatched location advantages with all utility points in close vicinity	3 tier 24x7 Security System
Project approved by MDDA	Ample parking space
Elegant elevation & Design	Modern of Fire Fighting System
Vastu & Eco friendly	External Development including sewer (STP) & underground water tank

UTTRAKHAND
RERA REGISTRATION NO. :
UKREP09170000023



Disclaimer : While every attempt has been made to ensure the accuracy of the plans shown, all measurements, positioning, fixtures, fittings and any other data shown are an approximate interpretation for illustrative purposes only and are not to scale. No responsibility is taken for any error, omission, miss-statement or use of data shown. The company reserves the right to make changes in the plans, specifications, dimensions and elevations without any prior notice. 1 sq. ft. = 0.0929 sq. mt., 1 sq. mt. = 10.764 sq. ft., 1 ft. = 0.305 mt. and 1 mt. = 3.281 ft.



GREEN VIEW

Blossom

Nurture your living

Disclaimer : While every attempt has been made to ensure the accuracy of the plans shown, all measurements, positioning, fixtures, fittings and any other data shown are an approximate interpretation for illustrative purposes only and are not to scale. No responsibility is taken for any error, omission, miss-statement or use of data shown. The company reserves the right to make changes in the plans, specifications, dimensions and elevations without any prior notice. 1 sq. ft. = 0.0929 sq. mt., 1 sq. mt. = 10.764 sq. ft., 1 ft. = 0.305 mt. and 1 mt. = 3.281 ft.

STUDIO APARTMENT TYPE-9
SUPER AREA 450 SQ.FT. (APPROX.)
RERA - CARPET AREA - 225.18 SQFT.

- STUDIO ROOM
- 1 KITCHEN
- 1 TOILETS
- 1 BALCONIES



1 BHK TYPE-11
SUPER AREA 700 SQ.FT. (APPROX.)
RERA - CARPET AREA - 395.25 SQFT.



- 1 LIVING - DINING
- 1 BEDROOM
- 1 TOILET
- 1 KITCHEN
- 1 BALCONY

2 BHK TYPE-10
SUPER AREA 1050 SQ.FT. (APPROX.)
RERA - CARPET AREA - 417.69 SQFT.



- 1 LIVING - DINING
- 2 BEDROOMS
- 1 KITCHEN
- 2 TOILETS
- 1 BALCONY

2 BHK TYPE-7
SUPER AREA
1150 SQ.FT.(APPROX.)
RERA - CARPET
AREA - 637.44 SQFT.



- 1 LIVING - DINING
- 2 BEDROOMS
- 1 KITCHEN
- 2 TOILETS
- 3 BALCONIES

2 BHK TYPE-8
SUPER AREA 1150 SQ.FT. (APPROX.)
RERA - CARPET AREA - 588.90 SQFT.



- 1 LIVING - DINING
- 2 BEDROOMS
- 1 KITCHEN
- 2 TOILETS
- 1 BALCONY

2 BHK TYPE-12
SUPER AREA 1150 SQ.FT. (APPROX.)
RERA - CARPET AREA - 588.90 SQFT.



- 1 LIVING - DINING
- 2 BEDROOMS
- 1 KITCHEN
- 2 TOILETS
- 2 BALCONIES

3 BHK TYPE-1

SUPER AREA - 1335 SQ.FT.(APPROX.)

RERA - CARPET AREA - 771.13 SQFT.

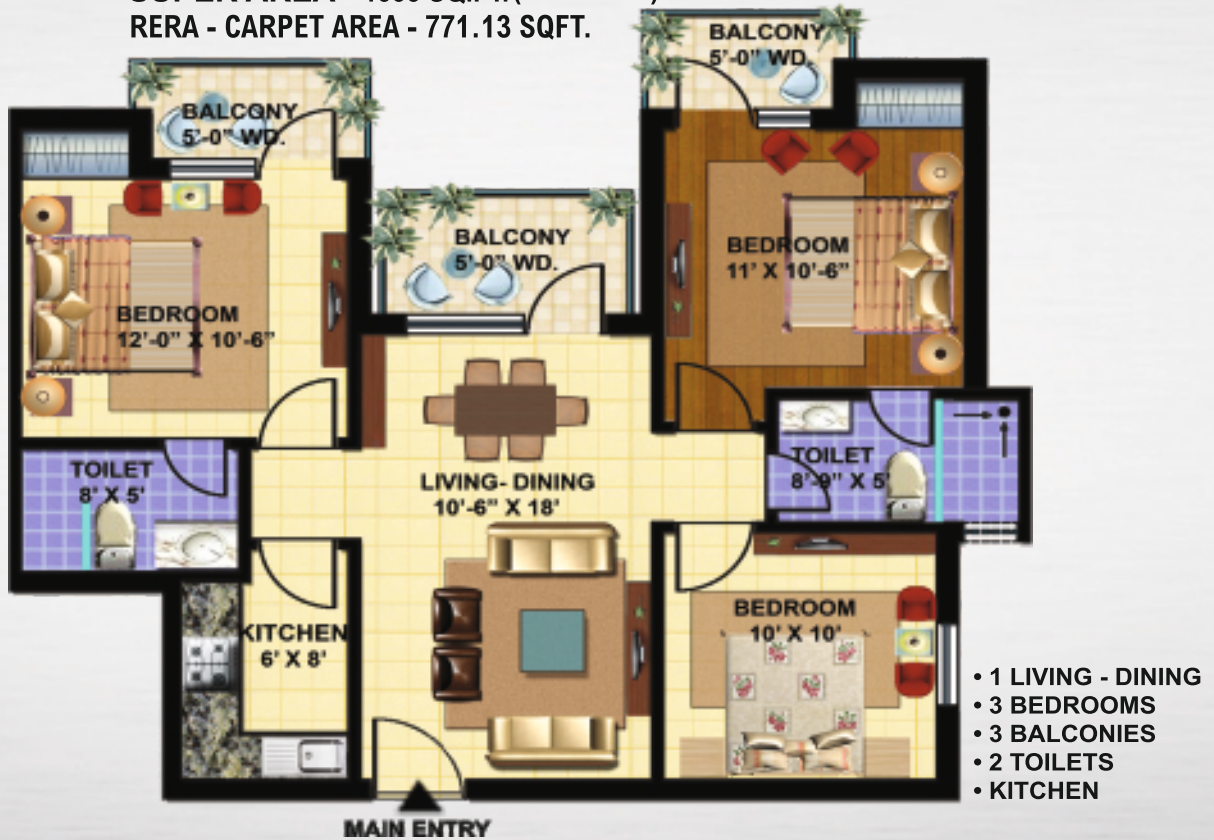

3 BHK TYPE-6

SUPER AREA
1335 SQ.FT.(APPROX.)

RERA - CARPET
AREA - 803.75 SQFT.



3 BHK TYPE-2 (A)
SUPER AREA
1460 SQ.FT. (APPROX.)
RERA - CARPET
AREA - 832.60 SQFT.



- 1 LIVING - DINING
- 3 BEDROOMS
- 2 BALCONIES
- 2 TOILETS
- 1 KITCHEN

3 BHK TYPE-2 (B)
SUPER AREA
1460 SQ.FT. (APPROX.)
RERA - CARPET
AREA - 814.08 SQFT.



- 1 LIVING - DINING
- 3 BEDROOMS
- 3 BALCONIES
- 2 TOILETS
- KITCHEN

**3 BHK TYPE-5
SUPER AREA
1600 SQ.FT. (APPROX.)
RERA - CARPET
AREA - 861.55 SQFT.**



**3 BHK + STORE TYPE-3 (A)
SUPER AREA 1810 SQ.FT. (APPROX.)
RERA - CARPET
AREA - 1006 SQFT.**



3 BHK + STORE TYPE-3 (B)
SUPER AREA 1810 SQ.FT. (APPROX.)
RERA - CARPET AREA - 994.49 SQFT.



SPECIFICATIONS

STRUCTURE

Earthquake resistant RCC frame structure. WALL FINISH : Elegant POP finishes with acrylic emulsion

FLOORING

Living / dining, bedrooms and kitchen adorned with vitrified tiles, master bedroom with wooden / vitrified. Anti skid ceramic tiles on toilet floors & glazed ceramic toilet walls.

KITCHEN

Contemporary modular kitchen with chimney, granite counter top with stainless steel sink and drainage. WALL : Fly Ash Bricks / AAC Blocks.

ELECTRIFICATION

FITTING : Modular electrical switches and plates (Anchor or Equivalent) ISI fittings & MCB.

WIRING : All electrical wiring in concealed conduit with ISI copper wire.

ELECTRIC FITTING : Tube Lights, Fans

ELEVATORS

8 Passenger Thyssenkrupp or equivalent. Intercom facility. One elevator with deep car stretcher.

TOILETS

PLUMBING FITTING : Branded fittings like Jaquar / Parryware or equivalent in all toilets.

SANITARY FITTINGS : WC China ware standard quality or equivalent in all toilets.

DOORS AND WINDOWS

DOORS : All doors are wooden frame with both sides laminated Flush/moulded Skin door shutters.

WINDOWS: UPVC three track sliding windows with clear glass and provision of mosquito nets.

POWER BACK-UP*

Diesel generator back-up.

EPABX.





LEGENDS :

1. PLANTING BED
2. RAMP ENTRY
3. PLANTING BED TYPE-2
4. BUILDING BLOCK
5. CORE
6. 1.0 M WD. PATHWAY
7. PLANTING BED TYPE-3
8. LANDSCAPE GREEN
9. 3.6 M WD. PATHWAY
10. COMMERCIAL USE
11. RAMP EXIT
12. HARD PAVED AREA
13. GUARD ROOM
14. ELECTRIC ROOM
15. CHILDREN'S PLAY ZONE

BLOCK A

TYPE - 4	3 BHK + SERVANT = 1990.00 SQ.FT.
TYPE - 5	3 BHK = 1600.00 SQ.FT. (Complete Area in Sqft.)
TYPE - 6	3 BHK = 1335.00 SQ.FT.

BLOCK B

TYPE - 1	3 BHK = 1335.00 SQ.FT.
TYPE - 2(A)	3 BHK = 1460.00 SQ.FT.
TYPE - 2(B)	3 BHK = 1460.00 SQ.FT.
TYPE - 3(A)	3 BHK + STORE = 1810.00 SQ.FT.
TYPE - 3(B)	3 BHK + STORE = 1810.00 SQ.FT.

BLOCK C

TYPE - 7	2 BHK = 1150.00 SQ.FT.
TYPE - 8	2 BHK = 1150.00 SQ.FT.
TYPE - 9	STUDIO APARTMENT = 450.00 SQ.FT.
TYPE - 10	2 BHK = 1050.00 SQ.FT.
TYPE - 11	1 BHK = 700.00 SQ.FT.
TYPE - 12	2 BHK = 1150.00 SQ.FT.



KEYPLAN:

BLOCK A

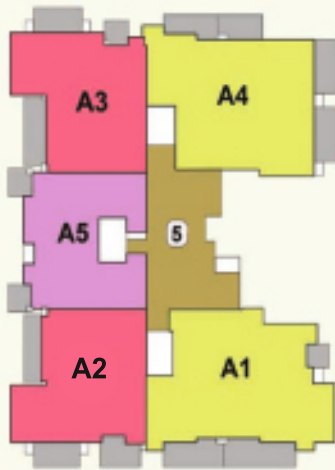

BLOCK B



BLOCK C



Disclaimer : While every attempt has been made to ensure the accuracy of the plans shown, all measurements, positioning, fixtures, fittings and any other data shown are an approximate interpretation for illustrative purposes only and are not to scale. No responsibility is taken for any error, omission, miss-statement or use of data shown.
The company reserves the right to make changes in the plans, specifications, dimensions and elevations without any prior notice. 1 sq. ft. = 0.0929 sq. mt., 1 sq. mt. = 10.764 sq. ft., 1 ft. = 0.305 mt. and 1 mt. = 3.281 ft.

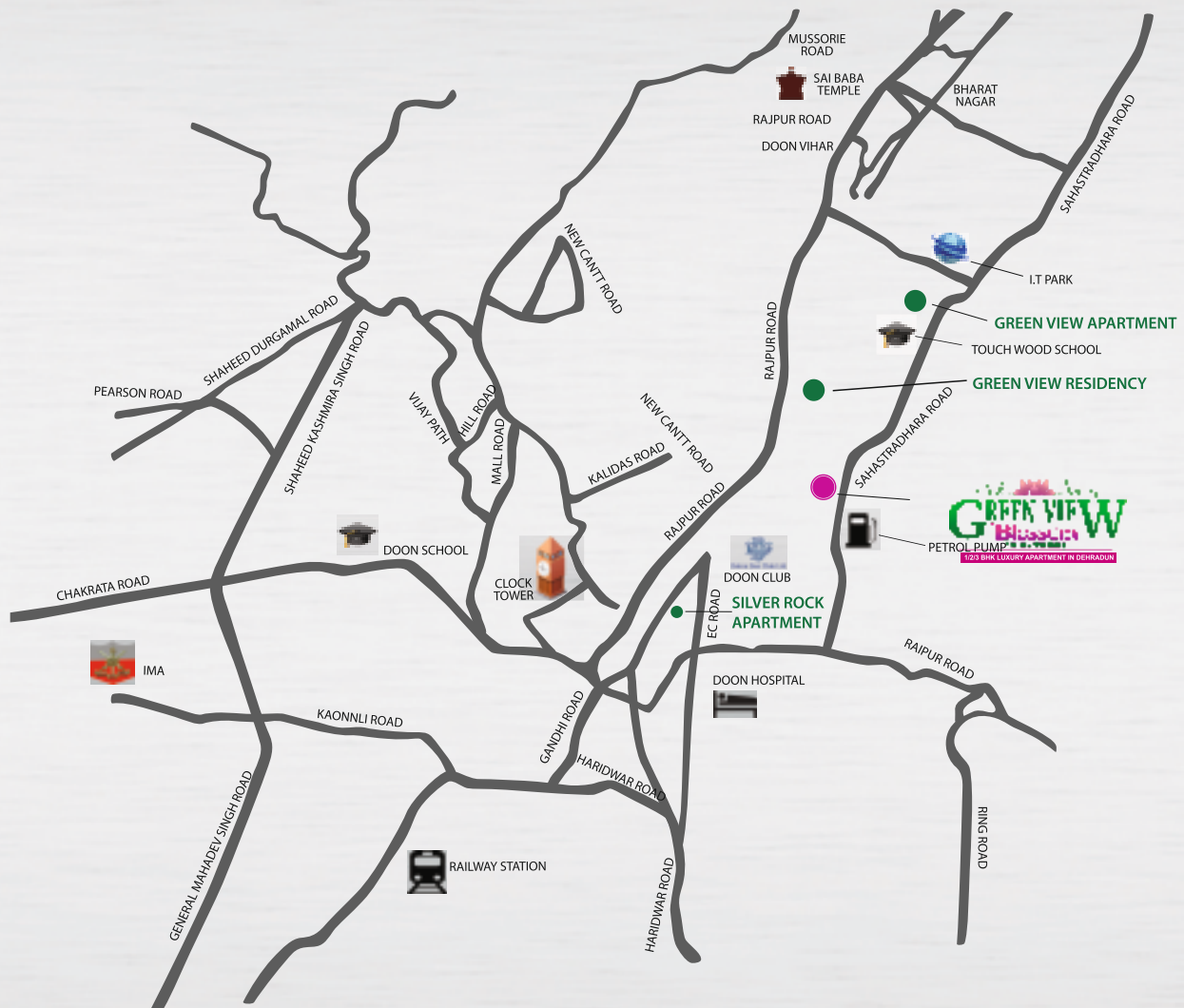

ACTUAL SITE IMAGE

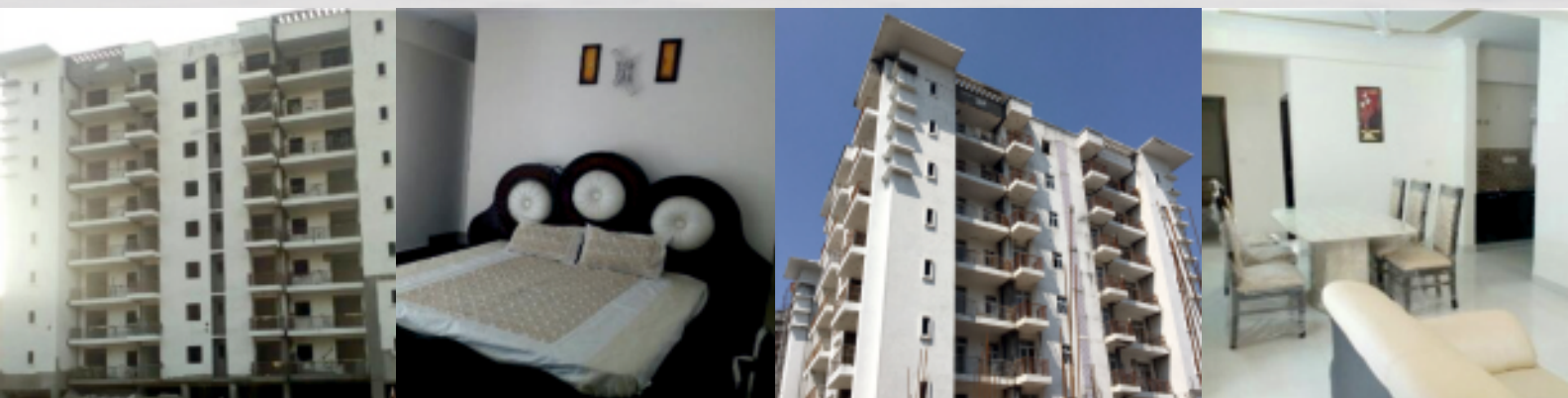

Complete Solutions of Luxurious Life

GAV DEVELOPERS (P) LTD.

(Formerly Known as GRAH AVAS VIKAS (P) LTD.)

CORPORATE OFFICE : SECTOR-5, PLOT NO-661, VAISHALI GHAZIABAD, (U.P.) PH: +91-9899950373

SITE OFFICE : GREEN VIEW BLOSSOM, MAIN SAHASTRADHARA ROAD,
NEAR I.T. PARK, DEHRADUN, UTTARAKHAND PH: +91-8881122999

WEBSITE : www.gavindia.com | E-mail : sales@gavindia.com